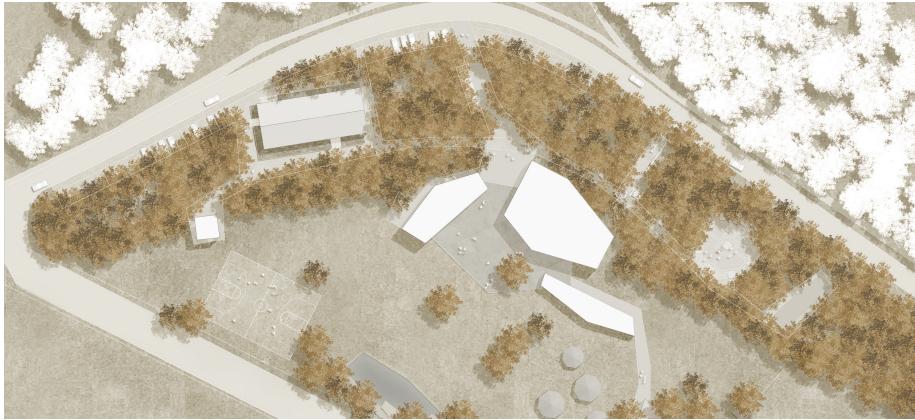

Youth Center of Understanding

Oberschleißheim
Completion 2010

Client: Landratsamt München
Cost: appr. 1.300.000 Euro
Area: 18.000 qm
Service Phases: Lph 1 - 9
Duration: 2007 - 2010
In collaboration with: Atelier 30, Kassel

Located at the heart of a large outdoor space, the project consists of a structural building ensemble symbolically paired with the open space of the youth center. Around this center, lies a tree grove of memories. This grove combines a lush tree field of robinia, chestnuts and grass plantings, in which a functional ribbon of museum and memory elements takes place.

As a central element, the spacious terrace stands out and forms the transition between the tree grove and the open multi-functional spaces, as well as a spatial unity with the airport premises. The layered sheets of large, broken-off airport fields serve as an additional retreat area, and as a demarcation of the airport area.



Youth Center of Understanding

Oberschleißheim
Completion 2010



Natural swimming pond

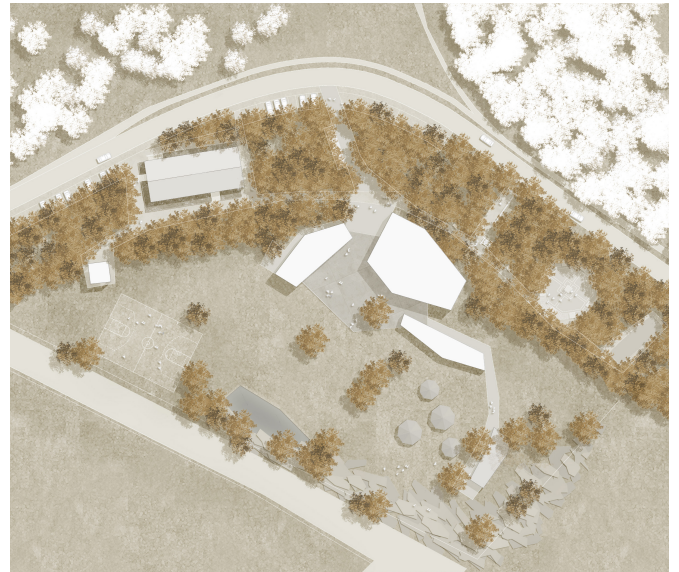

Campsite with a fireplace



Football field



Beach volleyball field